

ALLDAY
& MILLER



Greenway, Hayes, UB4 9HR
£465,000

2 1 1 C



Greenway, Hayes, UB4 9HR

£465,000

- Two Double Bedrooms
- No Onward Chain
- Commanding Views Over Green Fields
- Freehold House
- Easy Reach To An Elizabeth Line Station
- Modern Interiors Throughout
- Potential To Extend STPP
- Side Access
- Good Schools Nearby
- Close To Shops + Amenities

Description

This delightful home presents an excellent opportunity for those seeking a comfortable and modern living space. Upon entering, you are welcomed into a well presented reception room, perfect for relaxation or entertaining guests. The heart of the home is undoubtedly the modern fitted kitchen and dining room, which offers a stylish and functional space.

Rising to the first floor, you will find two inviting bedrooms, each providing a peaceful retreat for rest and relaxation. The front bedroom offers scenic views of the expansive green landscapes. The family bathroom is conveniently located completing this floor.

Outside, the property boasts a paved front garden which could easily be converted into a driveway for 2 cars. There is a private and secluded garden at the rear.

Situation

Nestled on a quiet residential road, Greenway offers a pleasant, community-oriented environment. The street enjoys close proximity to local green space at Belmore Playing Fields a real bonus for families, dog-walkers or anyone who values outdoor space. For families with children, the property is in catchment of several well-regarded schools nearby. Just a short stroll away you'll find Belmore Primary Academy and Downe Manor Primary School. The closest major rail station is Hayes & Harlington station roughly 1.9 miles away which offers good connectivity for commuters. The area benefits from good road links too, the A312 / A40 / M40 are accessible, which can be a real plus for drivers and those needing to reach Heathrow or surrounding regions quickly.



Floor Plans

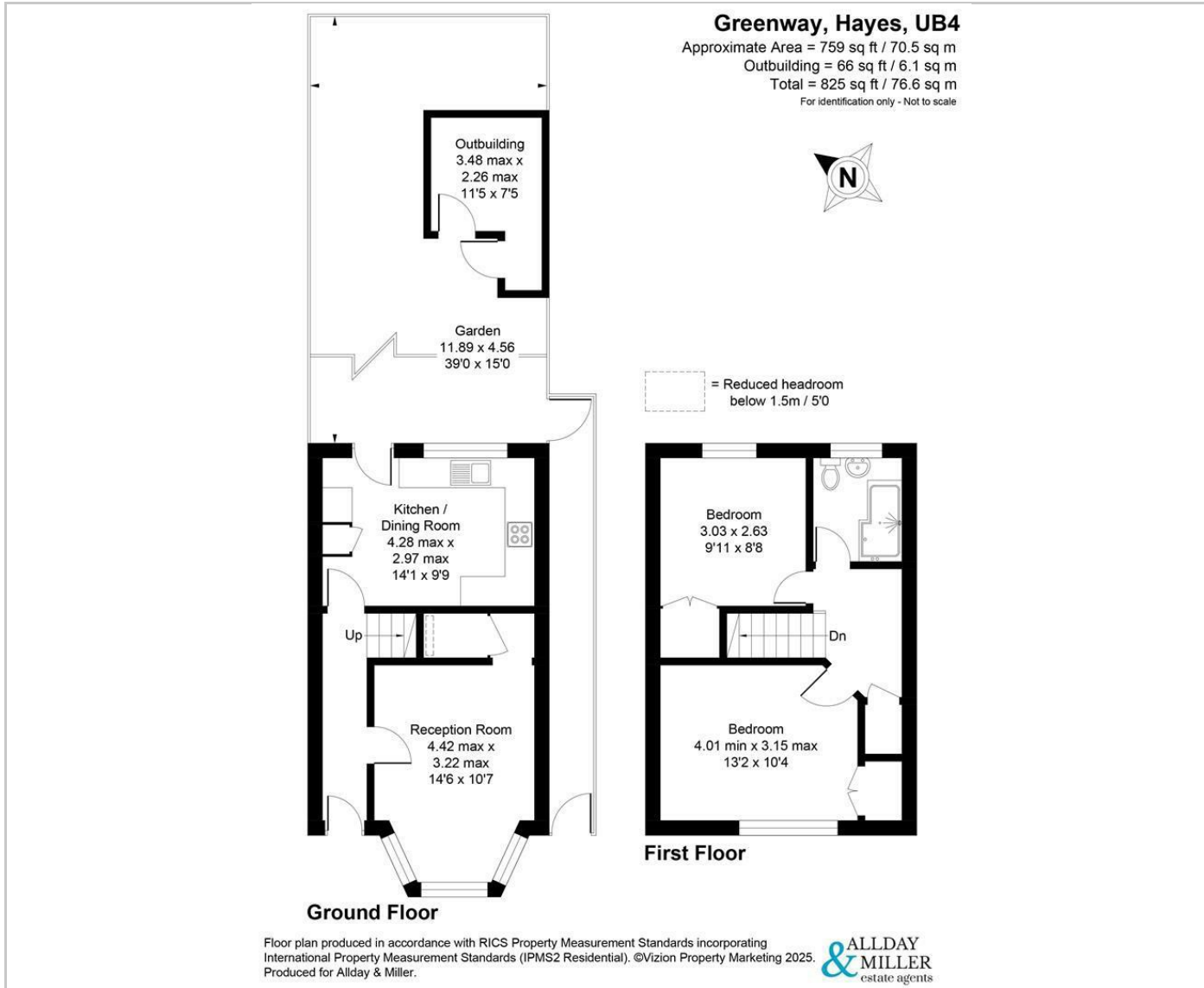

Area Map

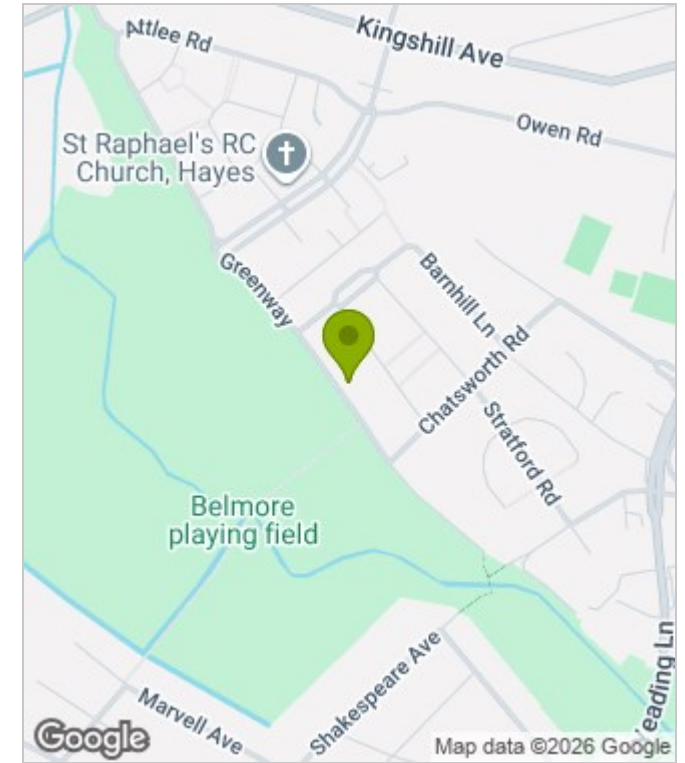

Energy Performance Graph

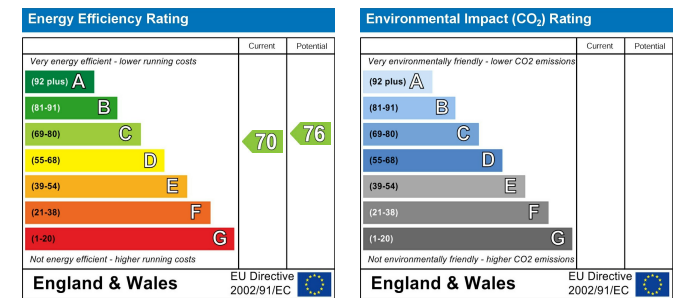

These particulars, whilst believed to be accurate are set out as a general outline only for guidance and do not constitute any part of an offer or contract. Intending purchasers should not rely on them as statements of representation of fact, but must satisfy themselves by inspection or otherwise as to their accuracy. No person in this firm's employment has the authority to make or give any representation or warranty in respect of the property.